

plot for sale Lloret De Mar, Selva



02 TERRENO:

Datos y Parametros Urbanos:

Dirección: Plus Font i Quer 7- Jardines de Santa Clotilde Nomenclatura: U/4
Superficie total: 4000m2 Altura máx. del terreno: 50mts sobre el nivel del mar.
Pendiente media: %33 Ocupación: 15% = 600mts Edificabilidad: 300mts
Retranqueo: 3mts Altura máxima: 7.50mts Niveles: Planta baja + 1

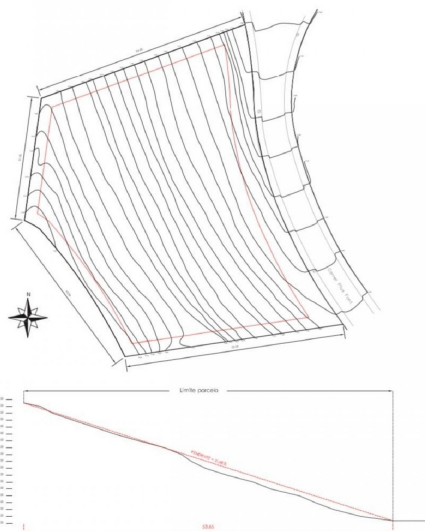

Land in an absolutely unique and privileged area, in 100 meters from the beach, surrounded by a lot of vegetation and beautiful mediterranean nature. ~ Total area of the land 4.000 m2. ~ Average slope: 33%. ~ Maximum terrain height 50 meters above sea level. ~ Occupancy: 15%. ~ Building area: 300 m2. ~ Maximum height allowed 7.50 meters. ~ Levels: ground floor + 1 floor.

property details

Spanishstate **6243885**
id:
reference:: **LCB001667**
close to/ located: **Lloret De Mar**
region: **Selva**
property type: **plot**
rooms: **not available**
property surface: **- m2**
surface plot: **4000 m2**
price: **€ 1.100.000**

contact

real estate agent: **Lighthouse Costa Brava**
name: **not available**
spreek: **not available**
telefoon: **+34972366023**